

SMA Straight Panel Receptacle Jack
Coaxial End

SMA2GFA50-1400E-EC/9X

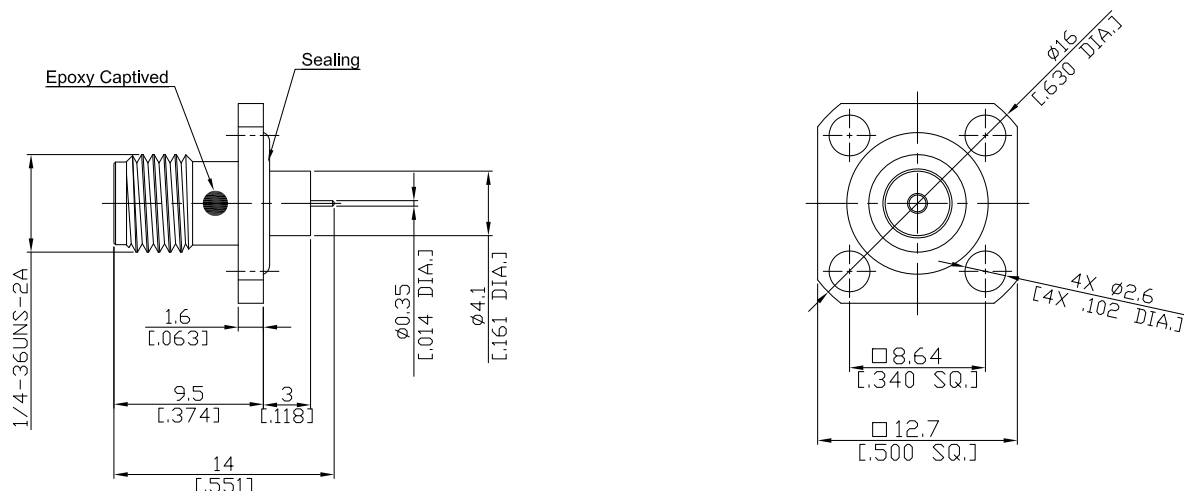

All dimensions are in mm [inch]

Tolerances according to DIN ISO 2768-mH

Interface

According to

IEC 60169-15; MIL-C-39012; MIL-STD-348A/310

Electrical Data

Impedance

50 Ω

Frequency

DC to 18 GHz

VSWR (Return Loss)

≤ 1.25 (≥ 19.08 dB)

Insertion Loss

≤ 0.03 x √F (GHz) dB

Mechanical Data

Coupling mechanisms

Screw-lock

Weight

N/A

Environmental Data

Temperature range

-65°C to +165°C

RoHS

compliant

IP Rating

IP67

Material And Plating

Piece Parts	Material	Plating
Centre contact	Beryllium Copper	Gold plating(Nickel underplated)
Body	Stainless Steel	Passivated
Insulator	PTFE	
Gasket	Silicone Rubber	

Packing

Single or 100